

**GÜÇLÜ BİR
GELECEK İÇİN**
STRONGER FOR
THE FUTURE



www.activent.com.tr



ACTIVENT®

**ÜRÜN KATALOĞU
PRODUCT CATALOGUE**

1 HÜCRELİ ASPIRATÖRLER CABINET FAN



HFAT

G2 METAL FİLTRELİ / G2 METAL FİLTİR
KAYIŞ-KASNAK TAHRİK MEKANİZMALI ÖNE EĞİMLİ
VE SIK KANATLI, ÇİFT EMİŞLİ RADYAL FANLI
HÜCRELİ ASPIRATÖR

BELT-PULLEY DRIVE MECHANISM DOUBLE
SUCTION CABINET FANS - METALIC FILTER
(FORWARD CURVED)

HFAT çift emişli santrifüj hücreli fanlar 1.000 m³/h ile 20.000 m³/h debileri arasında değişik boyutlarda üretilmektedir. Hücre panelleri 20 mm kalınlıkta ve 70 kg/m³ yoğunlukta kaya yünü izolelidir. Titreşimsiz çalışma özelliğine sahip, düşük enerji ile maksimum verim sağlarlar.

HIZ KONTROLÜ

Frekans invertörü ile sağlanabilirler.

MALZEME

Gövdesi; Galvaniz sacdan üretilmiştir. 20 mm kalınlığında kaya yünü izolelidir. Alüminyum kafes yapısında imal edilirler. Radyal fan, öne eğimli kanat yapısında galvaniz sacdan imal edilmiştir.

KULLANIM ALANLARI

İş yerleri, ofisler, fabrikalar, hastahaneler, restoranlar, toplantı salonları, süpermarketler, alışveriş merkezleri vb.

HFAT double suction centrifugal cell fans are produced in different sizes between 1.00 m³/h and 20.000 m³/h flow rates. The cell panels are rock wool insulated with a thickness of 20 mm and a density of 70 kg/m³. Flicker free. They have the feature of working and provide maximum efficiency with low energy.

SPEED CONTROL

Frequency inverter can be used.

MATERIAL

Body; It is made of galvanized sheet. 20 mm thick rock wool insulated. They are manufactured in aluminum cage structure. The radial fan is made of galvanized sheet metal with a forward-curved blade structure.

USAGE AREAS

Workplaces, offices, factories, hospitals, restaurants, meeting rooms, supermarkets, shopping malls and so on.

| Tip/Kod Type/Code | Fan Tipi Fan Type | Elektrik Motoru / Electrical Motor | | | | Max. Debi Air Flow m ³ / h | Max. Basınç Kaybı Pressure Pa |
|----------------------|----------------------|------------------------------------|--------------|------|----------------|--|--|
| | | Voltaj Voltage | Güç Power | | Devir Speed | | |
| | | (V) | (HP) | (kW) | (d/d) (rpm) | | |
| HFAT-07-1,00-T-4K | RCAT-07/07 | 380 | 1,00 | 0,75 | 1.410 | 2.250 | 300 |
| HFAT-07-1,50-T-4K | RCAT-07/07 | 380 | 1,50 | 1,10 | 1.430 | 2.800 | 300 |
| HFAT-09-1,50-T-4K | RCAT-09/09 | 380 | 1,50 | 1,10 | 1.430 | 4.000 | 250 |
| HFAT-09-2,00-T-4K | RCAT-09/09 | 380 | 2,00 | 1,50 | 1.430 | 5.000 | 125 |
| HFAT-10-2,00-T-4K | RCAT-10/10 | 380 | 2,00 | 1,50 | 1.430 | 5.500 | 225 |
| HFAT-10-3,00-T-4K | RCAT-10/10 | 380 | 3,00 | 2,20 | 1.435 | 6.500 | 225 |
| HFAT-12-3,00-T-4K | RCAT-12/12 | 380 | 3,00 | 2,20 | 1.435 | 7.500 | 300 |
| HFAT-12-4,00-T-4K | RCAT-12/12 | 380 | 4,00 | 3,00 | 1.435 | 8.500 | 350 |
| HFAT-15-4,00-T-4K | RCAT-15/15 | 380 | 4,00 | 3,00 | 1.435 | 10.000 | 350 |
| HFAT-15-5,50-T-4K | RCAT-15/15 | 380 | 5,50 | 4,00 | 1.455 | 12.000 | 350 |
| HFAT-18-7,50-T-4K | RCAT-18/18 | 380 | 7,50 | 5,50 | 1.465 | 18.000 | 250 |
| HFAT-18-10,0-T-4K | RCAT-18/18 | 380 | 10,0 | 7,50 | 1.465 | 20.000 | 275 |

DEĞER TABLOSU / VALUE CHART (m³ / h & Pa)

| Tip/Kod Type/Code | Hava Debileri (m ³ /h) / Air Flow (m ³ /h) | | | | | | | | | |
|----------------------|--|--------|--------|--------|--------|--------|--------|--------|--------|--------|
| | 100 Pa | 150 Pa | 200 Pa | 250 Pa | 300 Pa | 350 Pa | 450 Pa | 500 Pa | 600 Pa | 700 Pa |
| HFAT-07-1,00-T-4K | 2.600 | 2.500 | 2.450 | 2.350 | 2.250 | 2.150 | 2.050 | 1.850 | 1.600 | 1.350 |
| HFAT-07-1,50-T-4K | 3.150 | 3.000 | 3.000 | 2.900 | 2.800 | 2.750 | 2.650 | 2.500 | 2.300 | 2.150 |
| HFAT-09-1,50-T-4K | 4.500 | 4.200 | 4.200 | 4.050 | 3.900 | 3.750 | 3.550 | 3.200 | 2.750 | 2.300 |
| HFAT-09-2,00-T-4K | 5.100 | 4.950 | 4.850 | 4.700 | 4.550 | 4.450 | 4.300 | 4.000 | 3.650 | 3.300 |
| HFAT-10-2,00-T-4K | 5.900 | 5.650 | 5.550 | 5.400 | 5.200 | 5.000 | 4.800 | 4.350 | 3.850 | |
| HFAT-10-3,00-T-4K | 6.800 | 6.700 | 6.600 | 6.450 | 6.300 | 6.150 | 5.950 | 5.650 | 5.250 | 4.850 |
| HFAT-12-3,00-T-4K | 8.500 | 8.300 | 8.000 | 7.750 | 7.500 | 7.250 | 6.950 | 6.250 | 5.500 | |
| HFAT-12-4,00-T-4K | 9.600 | 8.500 | 9.200 | 9.000 | 8.750 | 8.500 | 8.250 | 7.750 | 7.200 | 6.500 |
| HFAT-15-4,00-T-4K | 11.750 | 10.500 | 11.250 | 10.900 | 10.550 | 10.200 | 9.800 | 8.900 | 7.800 | |
| HFAT-15-5,50-T-4K | 13.300 | 12.000 | 12.700 | 12.400 | 12.100 | 11.850 | 11.550 | 10.850 | 10.050 | |
| HFAT-18-7,50-T-4K | 19.000 | 16.500 | 18.000 | 17.550 | 17.050 | 16.550 | 16.050 | 15.000 | 13.800 | 12.600 |
| HFAT-18-10,0-T-4K | | 21.000 | 20.500 | 20.150 | 19.750 | 19.300 | 18.800 | 17.950 | 17.000 | |

TEKNİK ÖLÇÜLER / TECHNICAL DIMENSION

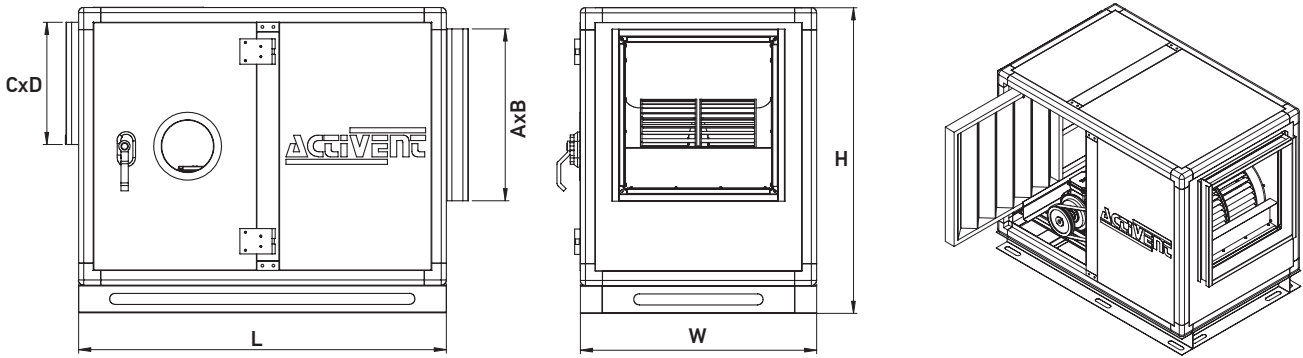

| Tip/Kod Type/Code | Ölçüler / Sizes (mm) | | | | | | |
|----------------------|----------------------|-------|-------|-----|-----|-----|-----|
| | L | W | H | A | B | C | D |
| HFAT-07/07 | 1.000 | 580 | 580 | 232 | 210 | 480 | 200 |
| HFAT-09/09 | 1.100 | 700 | 700 | 293 | 262 | 600 | 250 |
| HFAT-10/10 | 1.200 | 750 | 750 | 330 | 290 | 650 | 350 |
| HFAT-12/12 | 1.250 | 850 | 850 | 400 | 340 | 750 | 400 |
| HFAT-15/15 | 1.350 | 900 | 900 | 470 | 405 | 800 | 500 |
| HFAT-18/18 | 1.450 | 1.000 | 1.000 | 560 | 480 | 900 | 550 |

1 HÜCRELİ ASPİRATÖRLER CABINET FAN



HÜCRELİ FAN EMİŞ - ATIŞ YÖNLERİ / HÜCRELİ FAN EMİŞ - ATIŞ YÖNLERİ

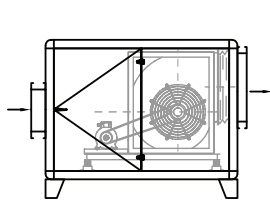

Yön : RYY

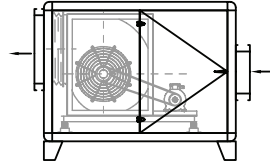

Yön : LYY

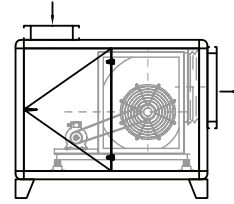

Yön : RUY

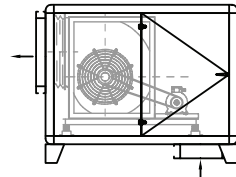

Yön : LAY

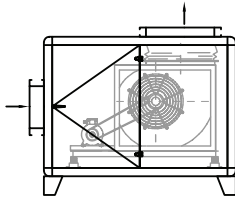

Yön : RYU

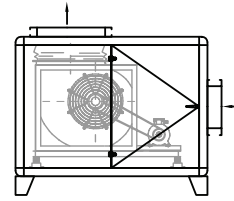

Yön : LYU

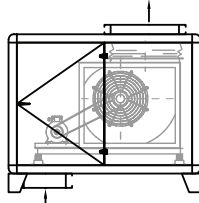

Yön : RAU

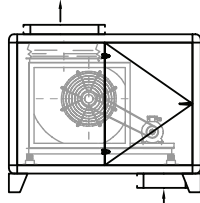

Yön : LAU

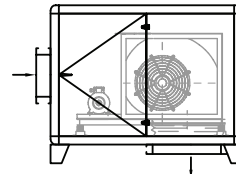

Yön : RYA

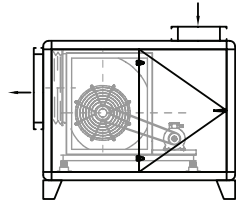

Yön : LUY

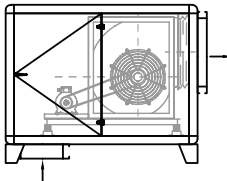

Yön : RAY

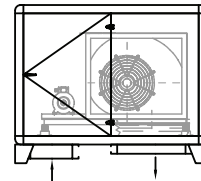

Yön : RAA

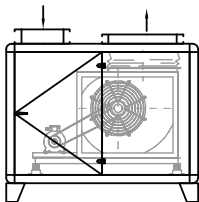

Yön : RUU

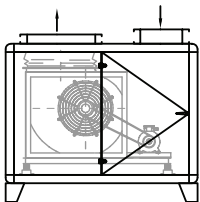

Yön : LUU

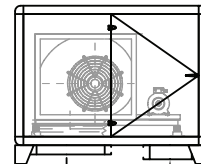

Yön : LAA

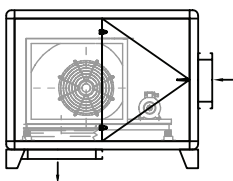

Yön : LYA

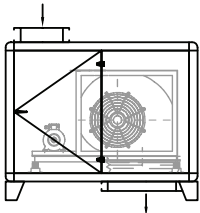

Yön : RUA

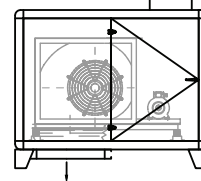

Yön : LUA



HFAT 07 / 07

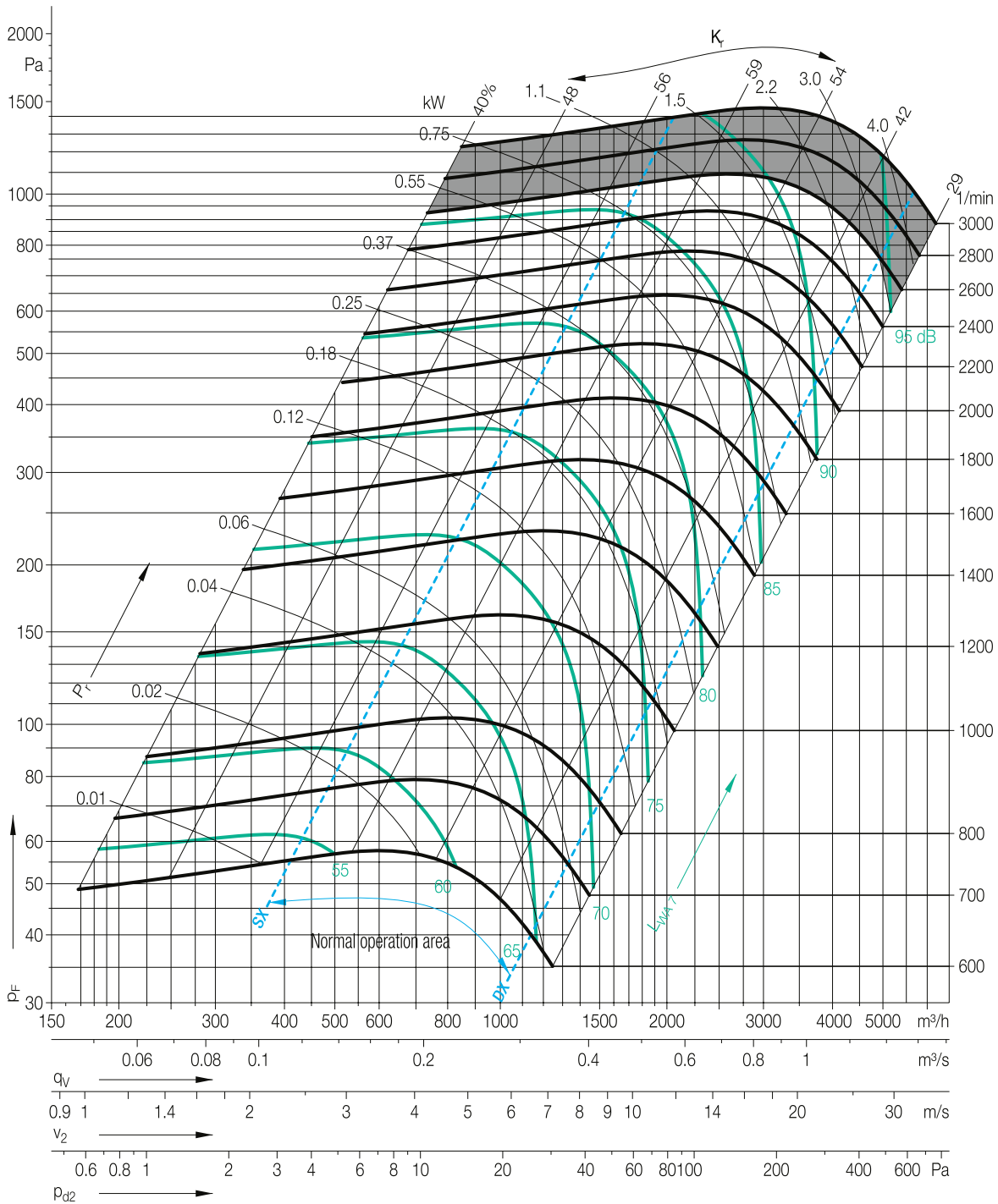

1 HÜCRELİ ASPIRATÖRLER CABINET FAN



HFAT 09 / 09

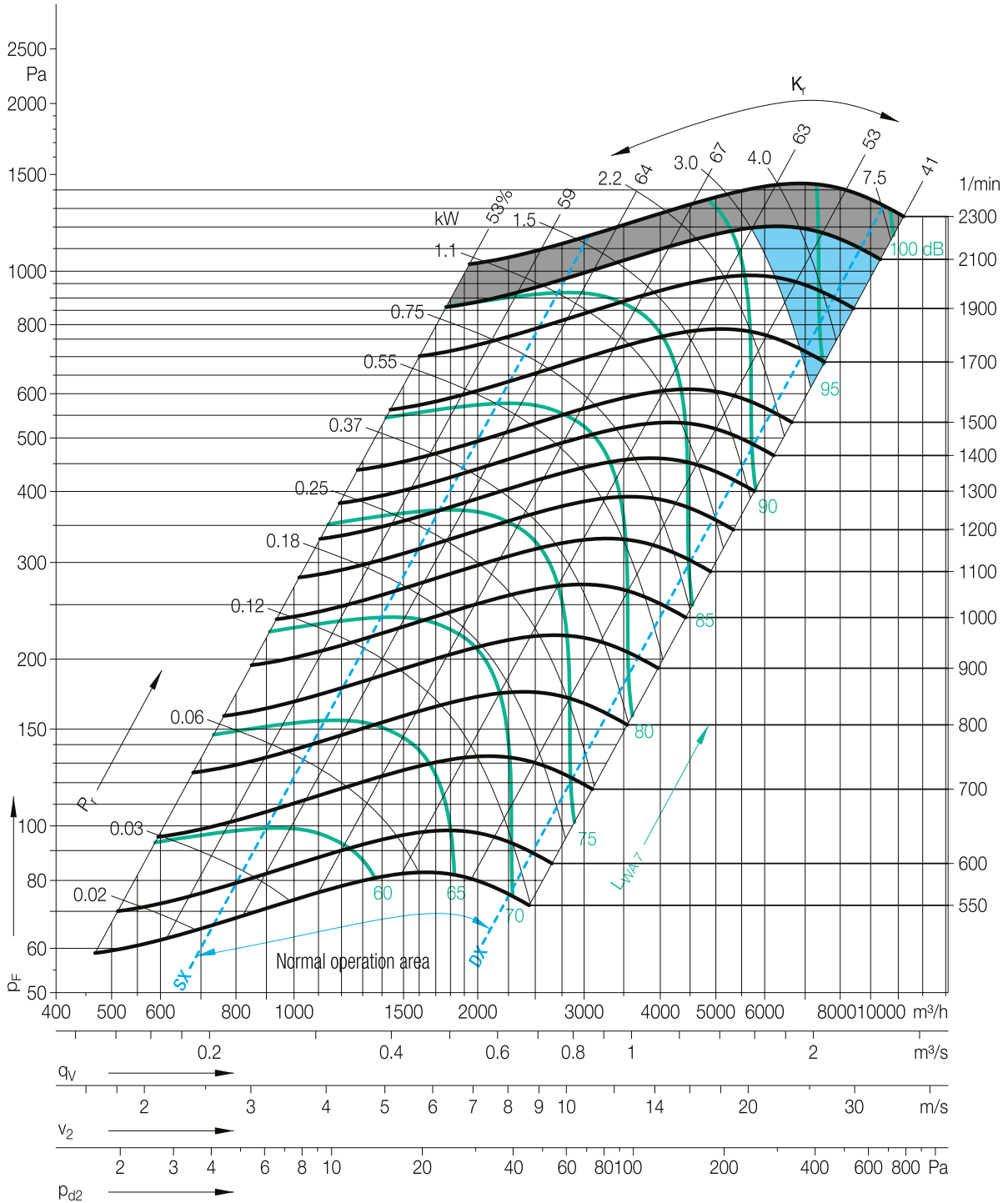



HFAT 10 / 10

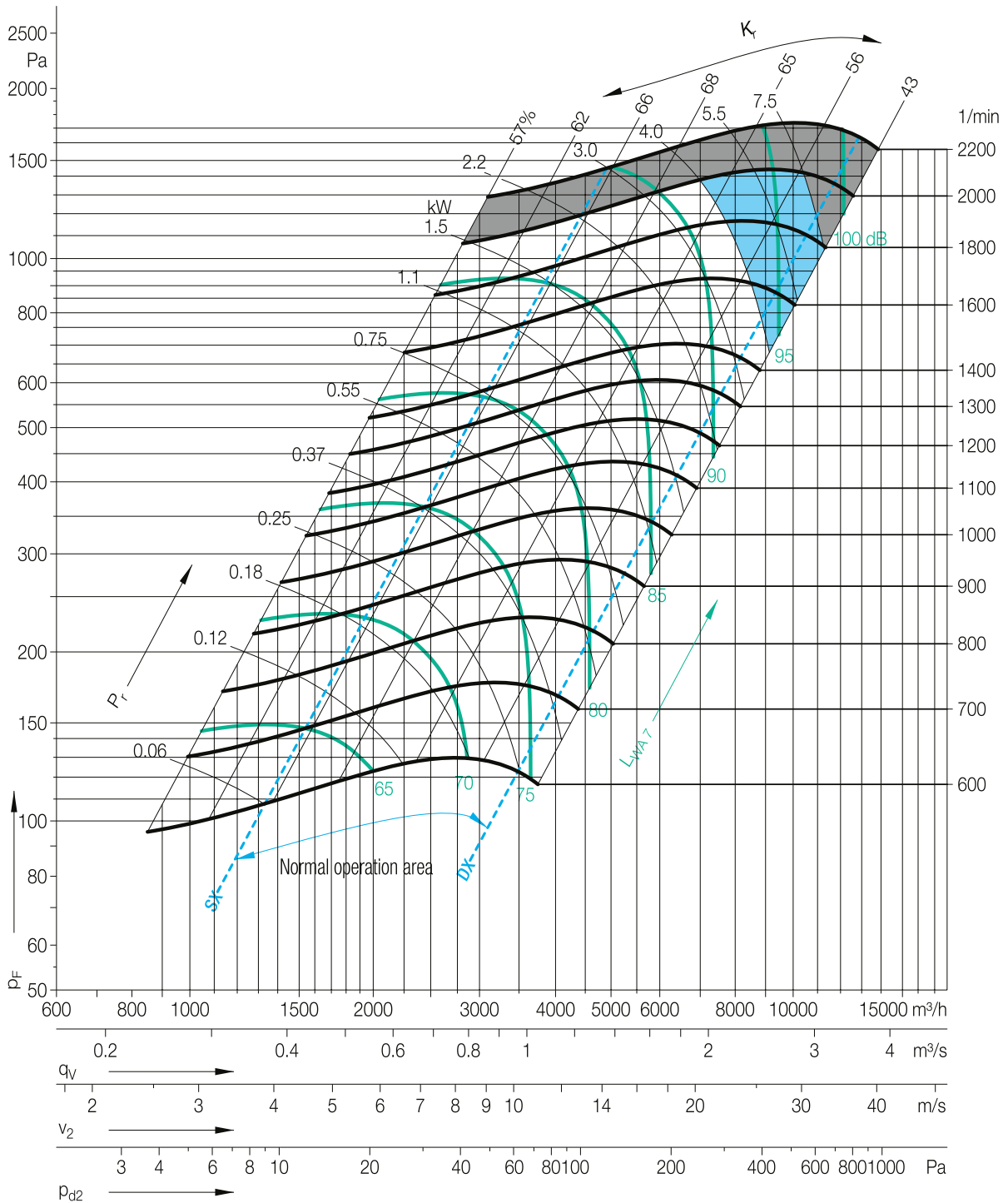

1 HÜCRELİ ASPIRATÖRLER CABINET FAN



HFAT 12 / 12

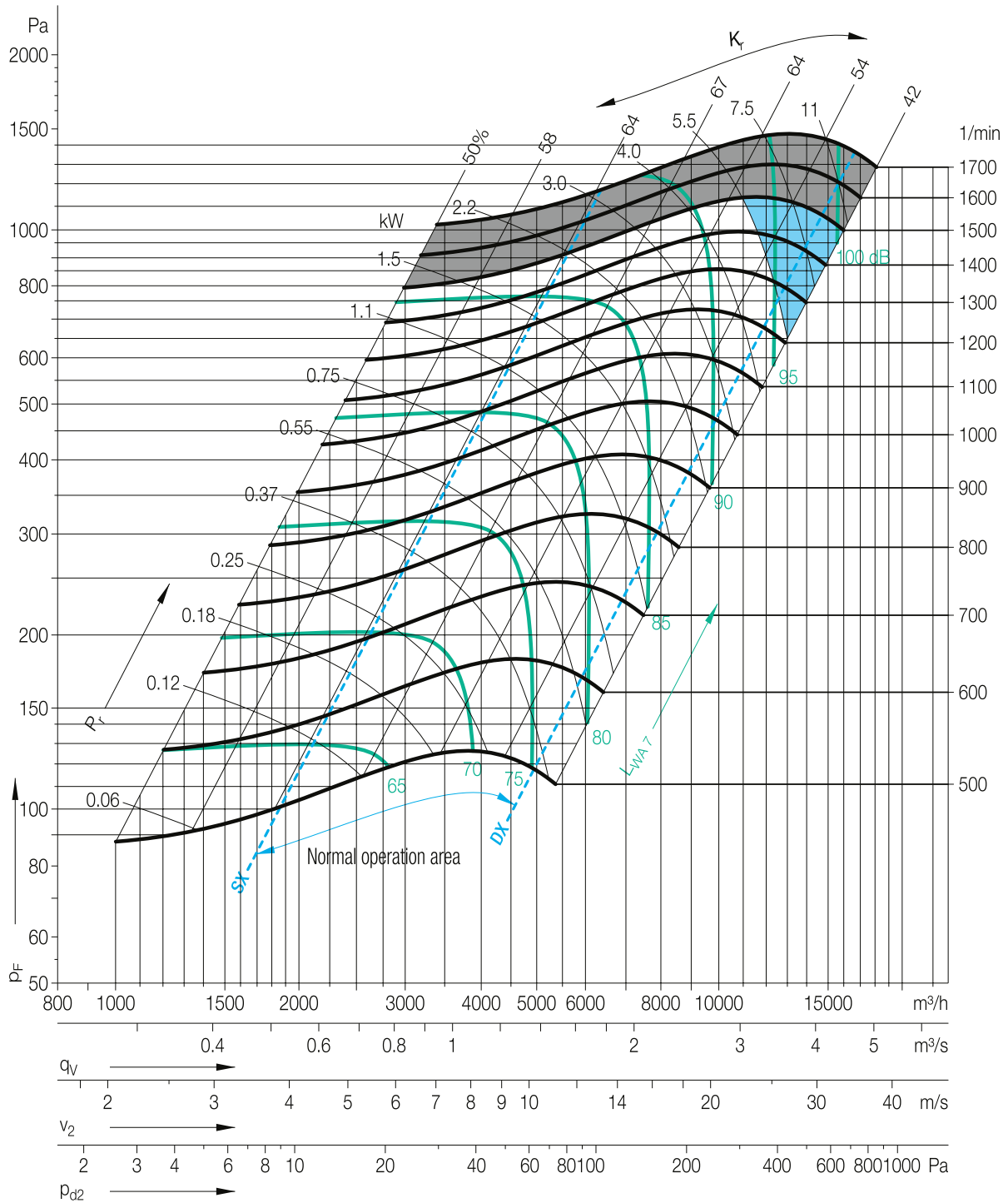



HFAT 15 / 15

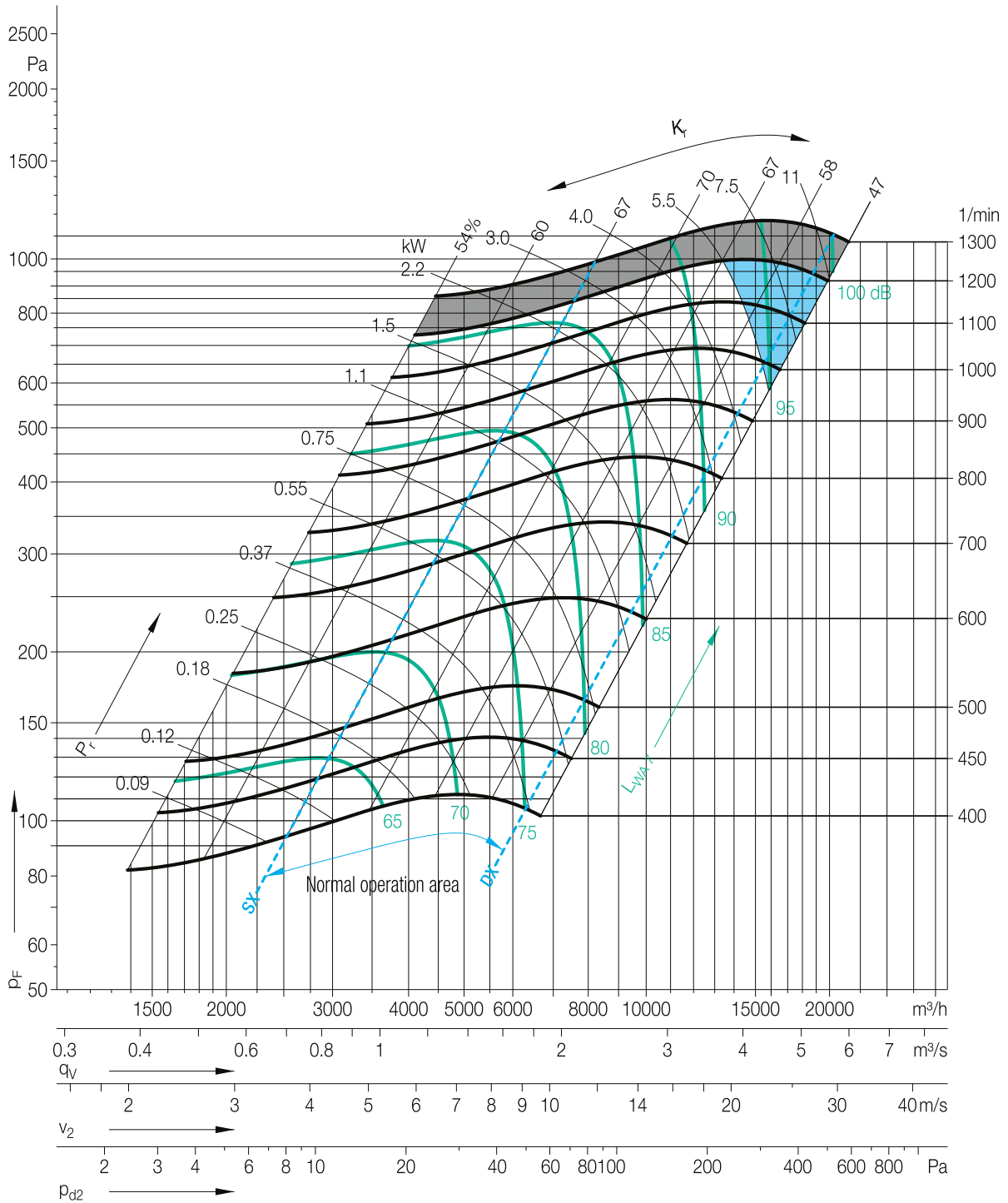

1 HÜCRELİ ASPİRATÖRLER CABINET FAN



HFAT 18 / 18

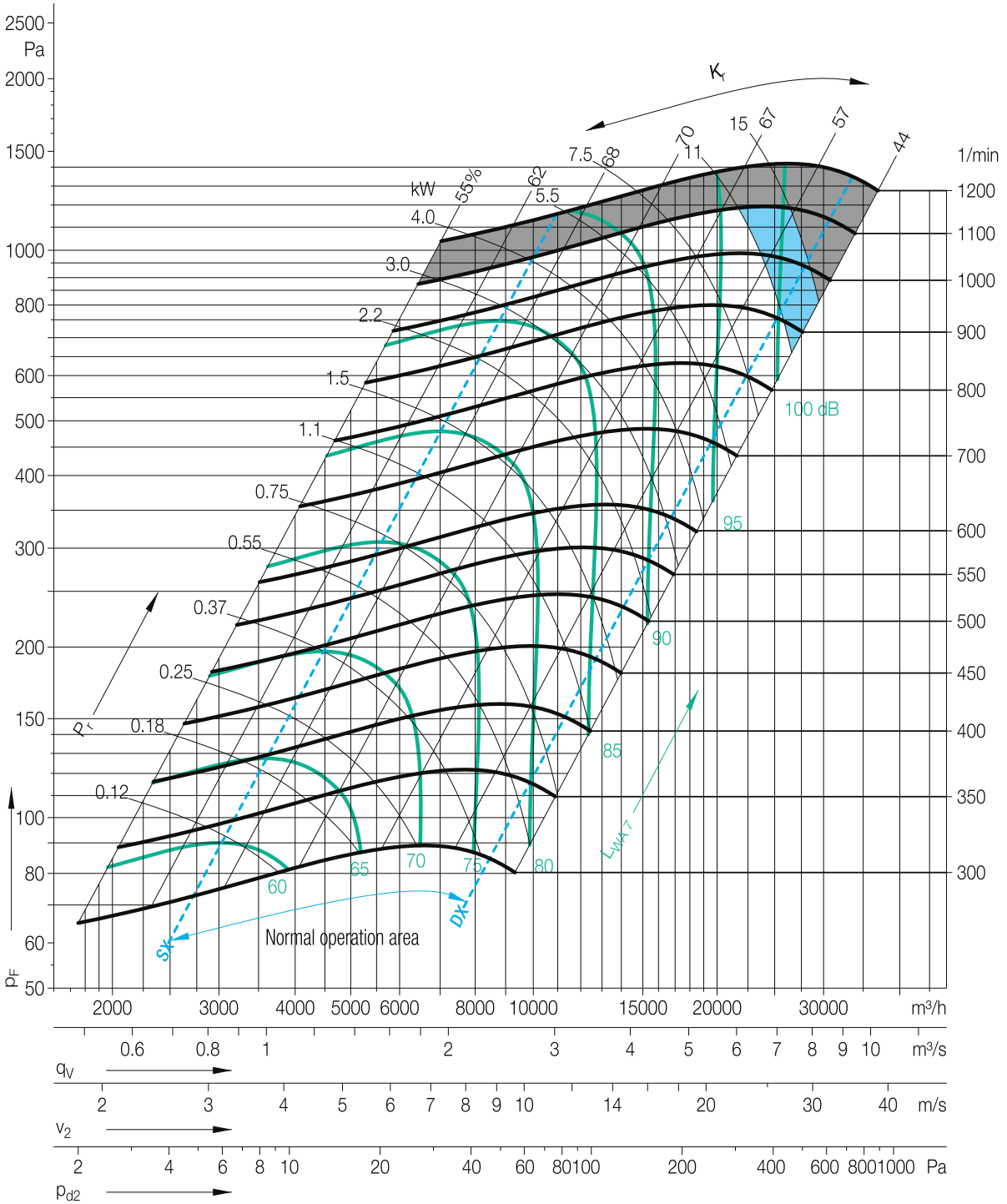

ACTIVENT®

Halkalı Merkez Mahallesi
Şehit Yılmaz Özdemir Caddesi
Sanayi Sokak No: 4
Küçükçekmece, İstanbul, Türkiye

P: +90.212 698 02 25

P: +90.212 698 02 26

P: +90.212 565 73 03

info@activent.com.tr

www.activent.com.tr

